

Halsey Taylor Owners Manual

HBW 8 & 13A-6-Q
USES HFC-134A REFRIGERANT

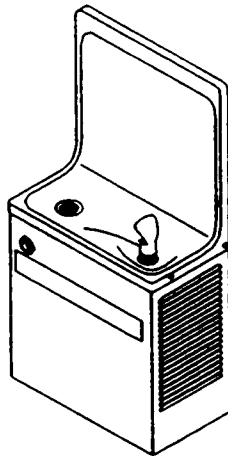

Installer

The HBW cooler is among the easiest to install Simulated Semi-Recessed cooler on the market today. To assure you install this model easily and correctly, PLEASE READ THESE SIMPLE INSTRUCTIONS BEFORE STARTING THE INSTALLATION. CHECK YOUR INSTALLATION FOR COMPLIANCE WITH PLUMBING, ELECTRICAL AND OTHER APPLICABLE CODES. After installation, leave these instructions inside the cooler for future reference.

IMPORTANT

ALL SERVICE TO BE PERFORMED BY AN AUTHORIZED SERVICE PERSON

1. Insure proper ventilation by maintaining 4" (min.) clearance from cabinet louvers to wall on each side of cooler.
2. Water supply 3/8" IPS. Waste 1-1/4" IPS. Contractor to supply waste trap and service stop valve in accordance with local codes.
3. Connecting lines should be thoroughly flushed to remove all foreign matter before being connected to cooler. This cooler is manufactured in such a manner that it does not in any way cause taste, odor, color or sediment problems.
4. Electrical: Insure power supply is identical in voltage, cycle and phase to that specified on the cooler data plate. NEVER wire compressor directly to the power supply.

For TROUBLE SHOOTING AND MAINTENANCE GUIDE, see page 4.

6. See TROUBLE SHOOTING AND MAINTENANCE GUIDE for care of Golden Bronzitone Models.

WIRING DIAGRAM

This drawing is merely for illustrating the components of the electrical system.

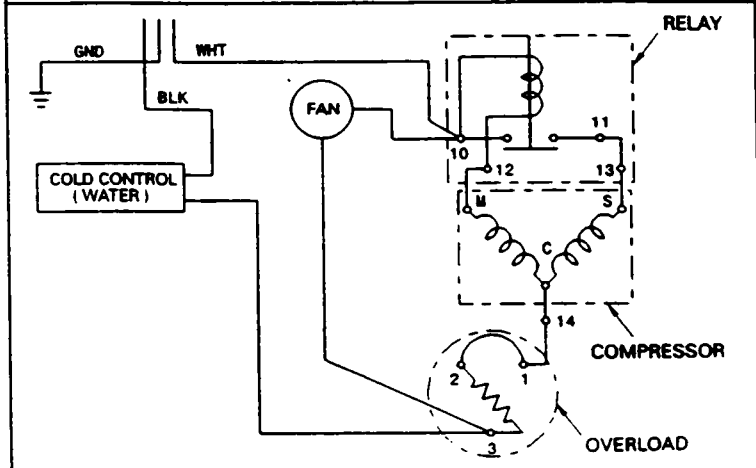

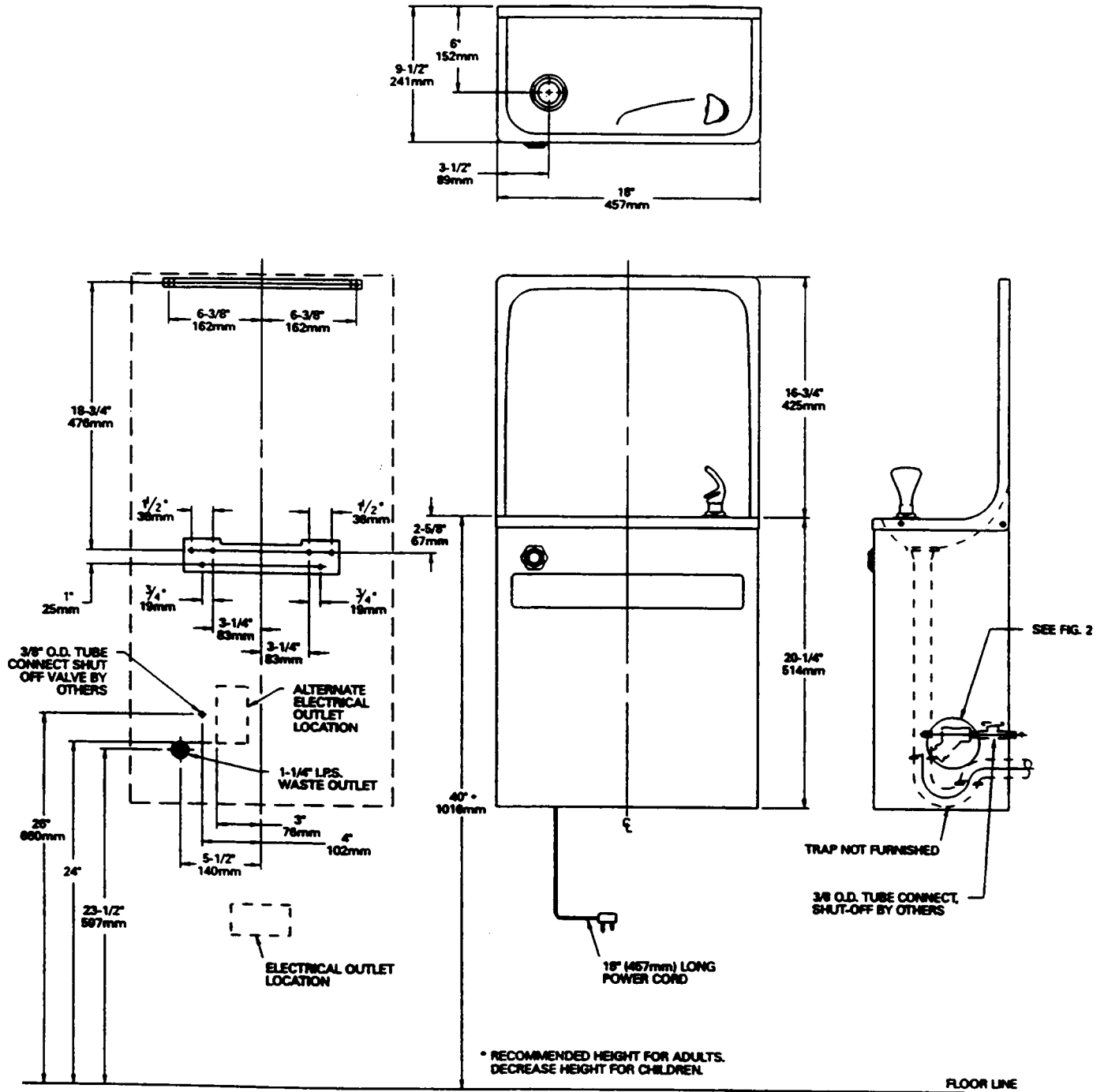

FIG. 1

HANGER BRACKET & TRAP INSTALLATION

IMPORTANT:

- 1). Remove hanger brackets fastened to back of cooler by removing screws.
 - 2). Mount the hanger brackets and trap as shown in Figure 1.
NOTE: Hanger brackets **MUST** be supported securely. Add fixture support carrier if wall will not provide adequate support.
 - 3). Install 3/8" IPS. female x 3/8" compression straight service stop to the building water inlet stub.
- 5 1/2 in. dimension from centerline of unit to centerline of trap must be maintained for proper fit.
 - Anchor hanger securely to wall using all mounting holes.

INSTALLATION OF COOLER

- 4). Hang the cooler on the hanger brackets. Be certain the hanger brackets are engaged properly in the frame and the basin.
- 5). Remove the access panel on the underside of the cooler and set it aside.
- 6). Connect the 3/8" O.D. water line from the cooler to the service stop valve. (See Fig.2 & 3)
- 7). **NOTE:** If required, the water inlet line to cooler may be cut to a desired length. However, if water line is cut, all burrs must be removed from outside of tube before reinserting into the Y-strainer.
- 8). Remove the slip nut and gasket from the trap and install them on the cooler waste line making sure that the end of the waste line fits into the trap. Assemble the slip nut and gasket to the trap and tighten securely.

START UP

- 9). Turn on the building water supply and check all connections for leaks.
- 10). Depress push button until all air is bled from cooler water system. A steady stream flow assures all air removed.
- 11). Stream height is factory set at 35 PSI. If supply pressure varies greatly from this, readjust stream height to approximately 1-1/2" above the bubbler guard by turning adjustment screw on regulator (Item 29), accessible by removing button & cover (Items 26 & 27).
- 12). Recheck all water and drain connections with water flowing through system.
- 13). Plug cooler power cord into building electrical receptacle.
- 14). Replace the access panel and secure by re-tightening all screws.

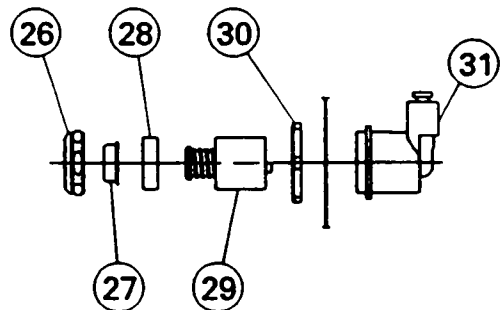
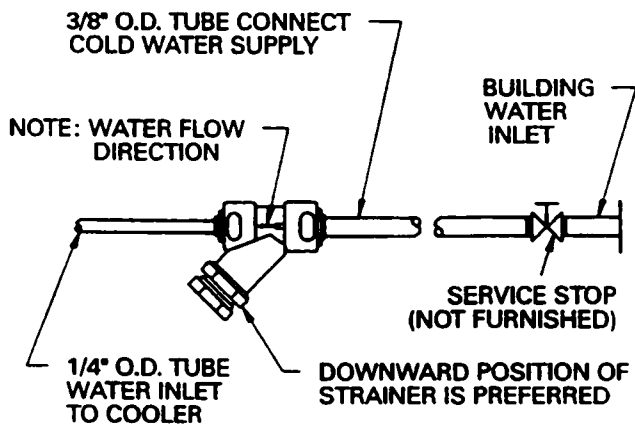

OPERATION OF QUICK CONNECT FITTINGS

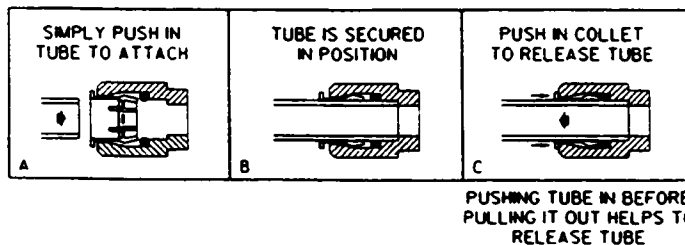

CORRECT STREAM HEIGHT

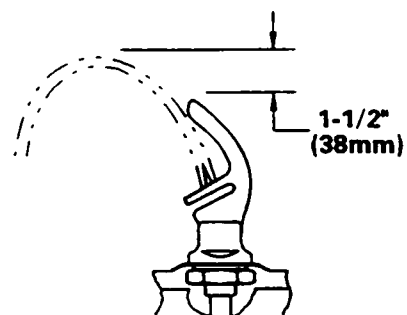

ITEM NO.	PART NO.	DESCRIPTION
1	31504C	Power Cord
2	27095C	Fan Bracket
3	30699C	Fan Blade
4	70018C	Hex Nut - Fan Blade
5	31490C	Fan Motor
6	70009C	Screw (Fan Motor)
7	50186C	Shroud - Fan
8	51544C	Bubbler
	51545C	Bubbler - Bronzestone
9	10079C	Nipple - Bubbler
10	61515C	Condenser
11	66202C	Drier
12*	35767C	Compressor Serv. Pak (Includes Items 13-15)
13	194243901550	Cover - Electrical Shield (Overload)
14	31025C	Overload /Relay Assembly
15	35766C	Cover - Terminal
16	66223C	Heat Exchanger
17	40041C	Tailpipe Assy (8 Gal)
	40429C	Precooler Assy (13 Gal)
18	26664C	Basin - Stainless Steel
	26657C	Basin - Bronzestone
19	70208C	Screw - Basin Mtg.
	70209C	Screw - Basin Mtg. (Bronzestone)
20	31513C	Cold Control
21	62220C	Evaporator Assembly
22	70788C	Y - Strainer (Ref. Fig. 2 on Page 3)
23	70772C	Drain Plug
24	70767C	Evaporator Retaining Clip
25	27239C	Bracket - Precooler
26	40089C	Cover
	40064C	Cover - Bronzestone
27	40048C	Button
	40065C	Button - Bronzestone
28	10031C	Retaining Nut
29	61313C	Regulator
30	40169C	Hex Nut
	40170C	Hex Nut - Bronzestone
31	50965C	Regulator Holder
32	40038C	Strainer - Beehive
	40111C	Strainer - Beehive (Bronzestone)
33	40619C	Ferrule - Tailpipe
34	40620C	Ferrule - Tailpipe (Bronzestone)
35	27093C	Angle - Front Corners
36	27282C	Bracket - Basin Mounting
37	27097C	Frame - Back/Bottom
38	27259C	Bracket - Front

* REPLACE WITH SAME COMPRESSOR USED IN ORIGINAL ASSEMBLY.
NOTE: All correspondence pertaining to HALSEY TAYLOR water coolers or orders for repair parts MUST include Model No. and Serial No. of cooler, name and part number of replacement part.

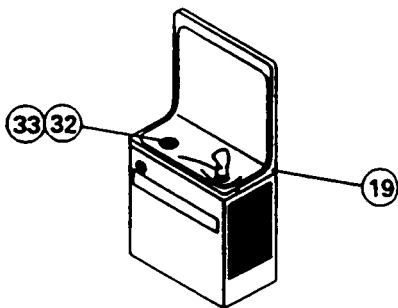

220V, 50 Hz. PARTS LIST

ITEM NO.	PART NO.	DESCRIPTION
5	31430C	MOTOR - FAN 4W 230V 50/60 Hz
12	31514C	COMPRESSOR 220V
14	31024C	OL/RELAY ASSY
15	35768C	COVER - RELAY
16	66249C	HEAT EXCHANGER

Halsey Taylor

P. O. BOX 9001
OAK BROOK, IL 60521
(708) 574-3500

PRINTED IN U.S.A.

TROUBLE SHOOTING & MAINTENANCE

- Bubbler:** If mineral deposits build up in the orifice, they can be removed by using a round file or small diameter wire. **CAUTION:** Care must be taken not to damage the orifice.
- Stream Regulator:** To adjust stream height see Instruction No. 11 under "START UP" Section on Page 3.
- Temperature Control:** Factory set for 50°F. water ($\pm 5^\circ$) under normal conditions. For colder water, adjust screw on Item No. 20 (see below). **CAUTION:** Do not force screw against stops. Turn clockwise for colder water, counterclockwise for warmer.
- Ventilation:** Condenser fins and louvers should be periodically cleaned with a brush, air hose or vacuum cleaner.
- Lubrication:** Motors are lifetime lubricated.
- CAUTION:** Cleaning of Golden Bronzestone Models requires special care. Outer surfaces must be cleaned with a mild detergent or mixture of vinegar and water only, rinsed and wiped dry. Abrasive and acidic cleaners may eventually damage the Golden Bronzestone finish.

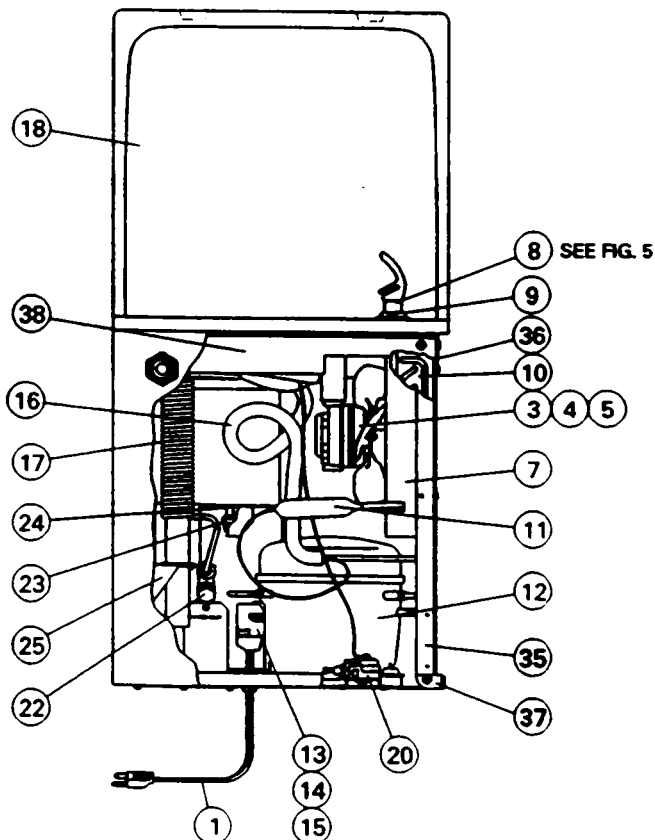
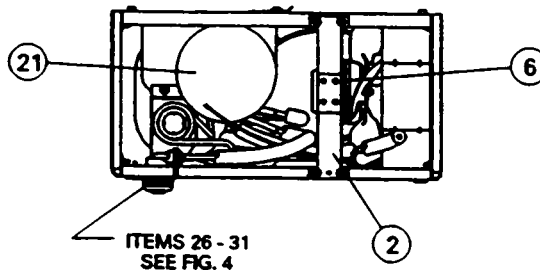

FOR PARTS, CONTACT YOUR LOCAL DISTRIBUTOR OR CALL 1-800-323-0620