

Halsey Taylor Owners Manual

HBW 8 & 13A-4-Q

USES HFC-134A REFRIGERANT

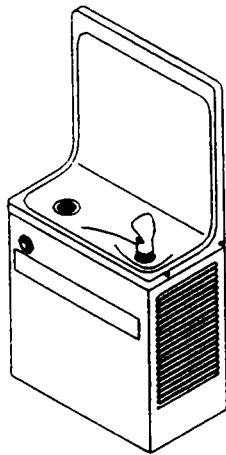

Installer

The HBW cooler is among the easiest to install Simulated Semi-Recessed cooler on the market today. To assure you install this model easily and correctly, PLEASE READ THESE SIMPLE INSTRUCTIONS BEFORE STARTING THE INSTALLATION. CHECK YOUR INSTALLATION FOR COMPLIANCE WITH PLUMBING, ELECTRICAL AND OTHER APPLICABLE CODES. After installation, leave these instructions inside the cooler for future reference.

IMPORTANT

ALL SERVICE TO BE PERFORMED BY AN AUTHORIZED SERVICE PERSON

1. Insure proper ventilation by maintaining 4" (min.) clearance from cabinet louvers to wall on each side of cooler.
2. Water supply 3/8" IPS. Waste 1-1/4" IPS. Contractor to supply waste trap and service stop valve in accordance with local codes.
3. Connecting lines should be thoroughly flushed to remove all foreign matter before being connected to cooler. This cooler is manufactured in such a manner that it does not in any way cause taste, odor, color or sediment problems.
4. Electrical: Insure power supply is identical in voltage, cycle and phase to that specified on the cooler data plate. NEVER wire compressor directly to the power supply.
5. For TROUBLE SHOOTING AND MAINTENANCE GUIDE, see page 4.
6. See TROUBLE SHOOTING AND MAINTENANCE GUIDE for care of Golden Bronzestone Models.

WIRING DIAGRAM

This drawing is merely for illustrating the components of the electrical system.

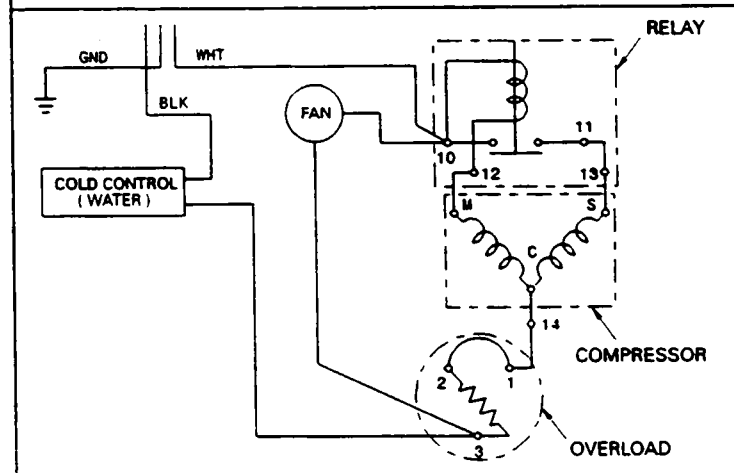

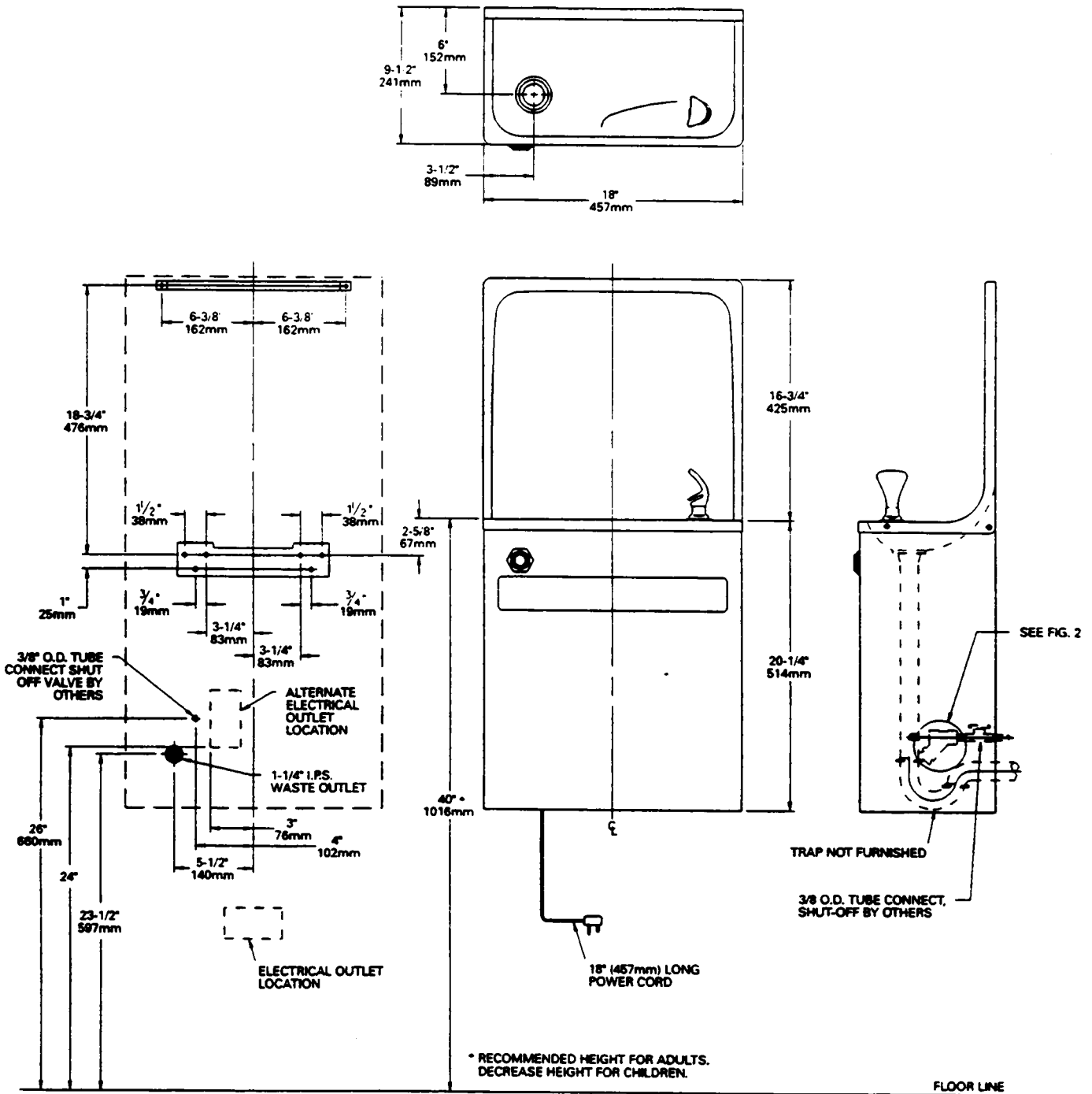

FIG. 1

HANGER BRACKET & TRAP INSTALLATION

- 1). Remove hanger brackets fastened to back of cooler by removing screws.
- 2). Mount the hanger brackets and trap as shown in Figure 1.
NOTE: Hanger brackets **MUST** be supported securely. Add fixture support carrier if wall will not provide adequate support.

IMPORTANT:

- 5 1/2 in. dimension from centerline of unit to centerline of trap must be maintained for proper fit.
 - Anchor hanger securely to wall using all mounting holes.
- 3). Install 3/8" IPS. female x 3/8" compression straight service stop to the building water inlet stub.

INSTALLATION OF COOLER

- 4). Hang the cooler on the hanger brackets. Be certain the hanger brackets are engaged properly in the frame and the basin.
- 5). Remove the access panel on the underside of the cooler and set it aside.
- 6). Connect the 3/8" O.D. water line from the cooler to the service stop valve. (See Fig.2 & 3)
- 7). **NOTE:** If required, the water inlet line to cooler may be cut to a desired length. However, if water line is cut, all burrs must be removed from outside of tube before reinserting into the Y-strainer.
- 8). Remove the slip nut and gasket from the trap and install them on the cooler waste line making sure that the end of the waste line fits into the trap. Assemble the slip nut and gasket to the trap and tighten securely.

START UP

- 9). Turn on the building water supply and check all connections for leaks.
- 10). Depress push button until all air is bled from cooler water system. A steady stream flow assures all air removed.
- 11). Stream height is factory set at 35 PSI. If supply pressure varies greatly from this, readjust stream height to approximately 1-1/2" above the bubbler guard by turning adjustment screw on regulator (Item 29), accessible by removing button & cover (Items 26 & 27).
- 12). Recheck all water and drain connections with water flowing through system.
- 13). Plug cooler power cord into building electrical receptacle.
- 14). Replace the access panel and secure by re-tightening all screws.

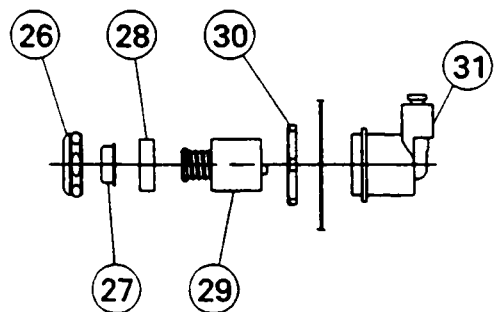
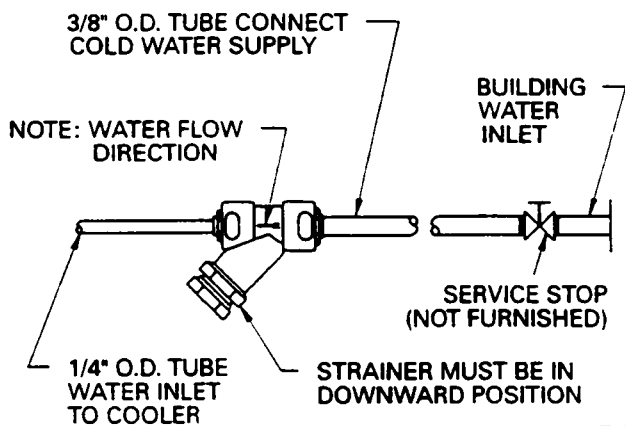

OPERATION OF QUICK CONNECT FITTINGS

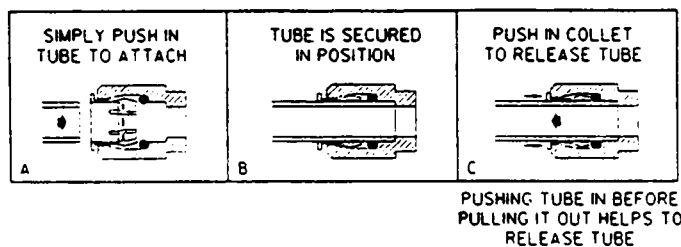

CORRECT STREAM HEIGHT

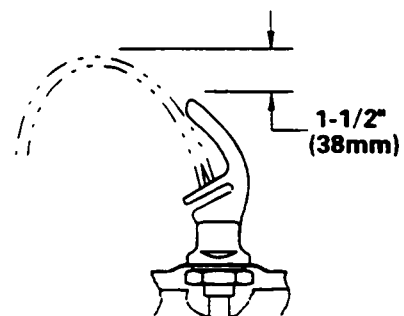

TROUBLE SHOOTING & MAINTENANCE

1. **Bubbler:** If mineral deposits build up in the orifice, they can be removed by using a round file or small diameter wire.
CAUTION: Care must be taken not to damage the orifice.
2. **Stream Regulator:** To adjust stream height see Instruction No. 11 under "START UP" Section on Page 3.
3. **Temperature Control:** Factory set for 50° F. water ($\pm 5^\circ$) under normal conditions. For colder water, adjust screw on Item No. 20 (see below).
CAUTION: Do not force screw against stops. Turn clockwise for colder water, counterclockwise for warmer.
4. **Ventilation:** Condenser fins and louvers should be periodically cleaned with a brush, air hose or vacuum cleaner.
5. **Lubrication:** Motors are lifetime lubricated.
6. **CAUTION:** Cleaning of Golden Bronzestone Models requires special care. Outer surfaces must be cleaned with a mild detergent or mixture of vinegar and water only, rinsed and wiped dry. Abrasive and acidic cleaners may eventually damage the Golden Bronzestone finish.

ITEM NO.	PART NO.	DESCRIPTION
1	31504-C	Power Cord
2	20617-C	Fan Bracket
3	30699-C	Fan Blade
4	70018-C	Hex Nut - Fan Blade
5	31490-C	Fan Motor
6	70009-C	Screw (Fan Motor)
7	50186-C	Shroud - Fan
8	51544-C	Bubbler
	51545-C	Bubbler - Bronzestone
9	10079-C	Nipple - Bubbler
10	61515-C	Condenser
11	66202-C	Drier
12*	35767-C	Compressor Serv. Pak (Includes Items 13-15)
13	19-42439-01-550	Cover - Electrical Shield (Overload)
14	31025-C	Overload /Relay Assembly
15	35766-C	Cover - Terminal
16	66223-C	Heat Exchanger
17	40041-C	Tailpipe Assy (8 Gal)
	40429-C	Precooler Assy (13 Gal)
18	26664-C	Basin - Stainless Steel
	26957-C	Basin - Bronzestone
19	70208-C	Screw - Basin Mtg.
	70209-C	Screw - Basin Mtg. (Bronzestone)
20	31513-C	Cold Control
21	62220-C	Evaporator Assembly
22	70788-C	Y - Strainer (Ref. Fig. 2 on Page 3)
23	70772-C	Drain Plug
24	70767-C	Evaporator Retaining Clip
25	26699-C	Bracket - Tailpipe
26	40089-C	Cover
	40064-C	Cover - Bronzestone
27	40048-C	Button
	40065-C	Button - Bronzestone
28	10031-C	Retaining Nut
29	61313-C	Regulator
30	40169-C	Hex Nut
	40170-C	Hex Nut - Bronzestone
31	50985-C	Regulator Holder
32	40038-C	Strainer - Beehive
	40111-C	Strainer - Beehive (Bronzestone)
33	40619-C	Ferrule - Tailpipe
	40620-C	Ferrule - Tailpipe (Bronzestone)

* REPLACE WITH SAME COMPRESSOR USED IN ORIGINAL ASSEMBLY.
NOTE: All correspondence pertaining to HALSEY TAYLOR water coolers or orders for repair parts MUST include Model No. and Serial No. of cooler, name and part number of replacement part.

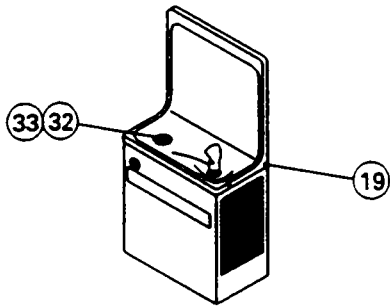

220V, 50 Hz. PARTS LIST

ITEM NO.	PART NO.	DESCRIPTION
5	31430-C	MOTOR - FAN 4W 230V 50/60 Hz
12	31514-C	COMPRESSOR 220V
14	31024-C	OL/RELAY ASSY
15	35768-C	COVER - RELAY
16	66249-C	HEAT EXCHANGER

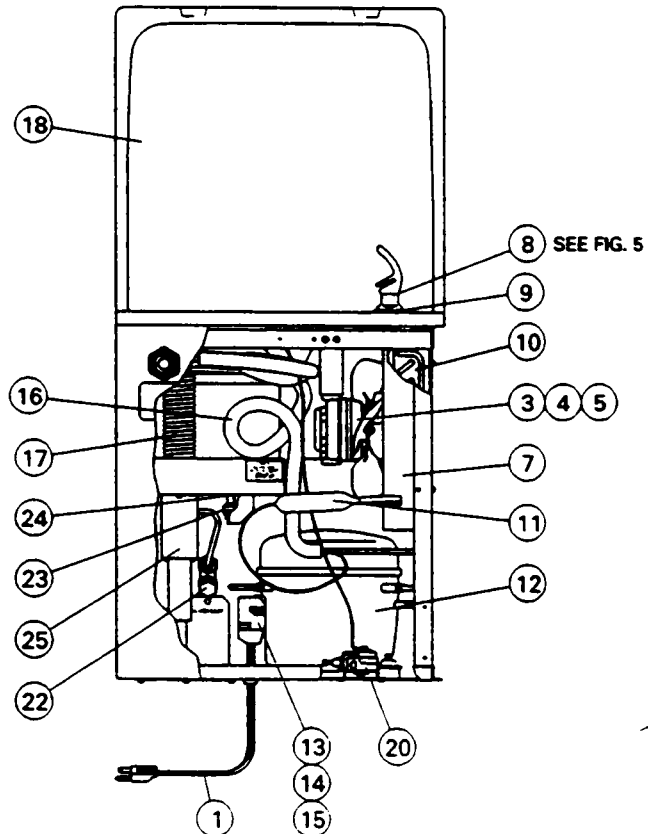
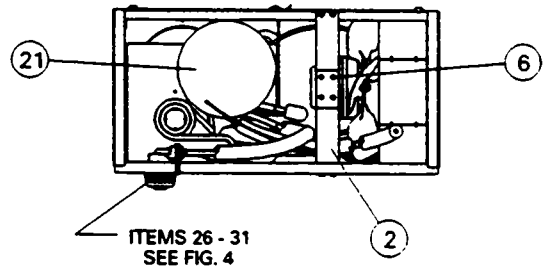

Halsey Taylor

P. O. BOX 9001
OAK BROOK, IL 60521
(708) 574-3500

PRINTED IN U. S. A.

FOR PARTS, CONTACT YOUR LOCAL DISTRIBUTOR OR CALL 1-800-323-0620